



Sonar Guide

USER INSTRUCTIONS

For
Rollators
(NITRO
shown*)



The **Sonar Guide** alerts the user to drop-offs, step-ups, and low-level obstacles in their path of travel.

* Adapters for both the NITRO and Dolomite are included.

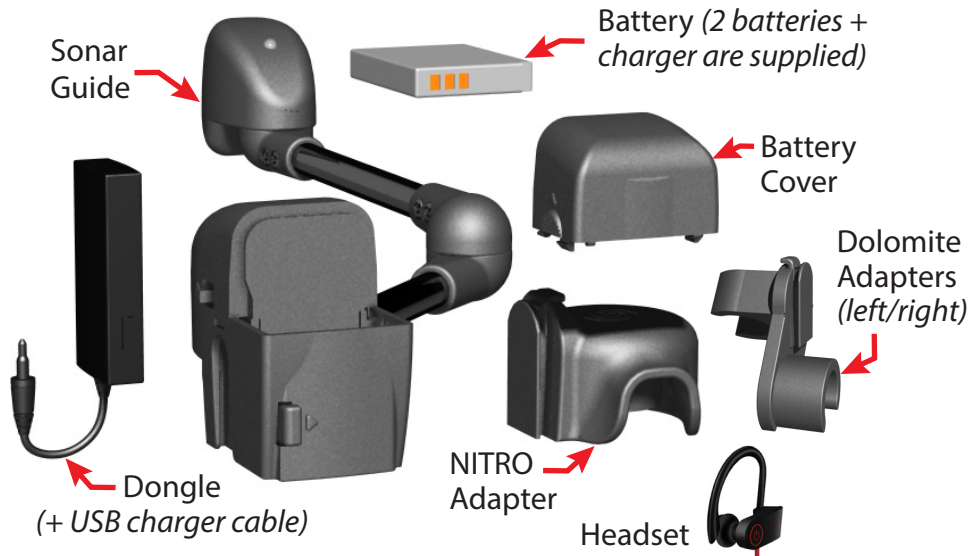

1 Install Mounting Adapter

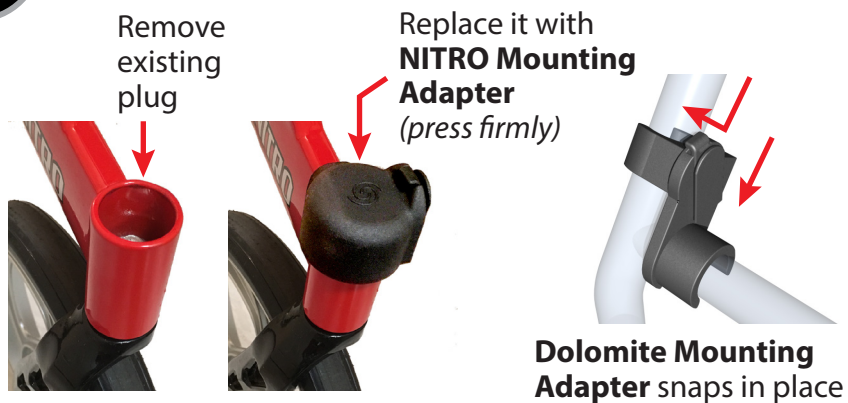

2 Install Sonar Guide

- Slide the unit down onto **Mounting Adapter** until the catch clicks. To remove push the catch away from the unit, and slide the unit upwards.



Mounting Adapters:

3 Insert Dongle and Battery

- The headset included in the kit is **paired**, and shouldn't need pairing (for your own headset follow its manufacturer's instructions). Paired headset and dongle both flash **blue slowly** when turned on. **If pairing is needed:**
 - press and hold **dongle** power button until its light flashes **blue/red** (6 seconds), then release the power button.
 - place your **headset** within 3 feet of the dongle, and **press and hold** power button until light flashes **blue/red** for 3 seconds, then release the button. Wait for devices to pair (~1 min.)
- Remove Battery Cover, and insert Dongle and Battery as shown (both should be charged).

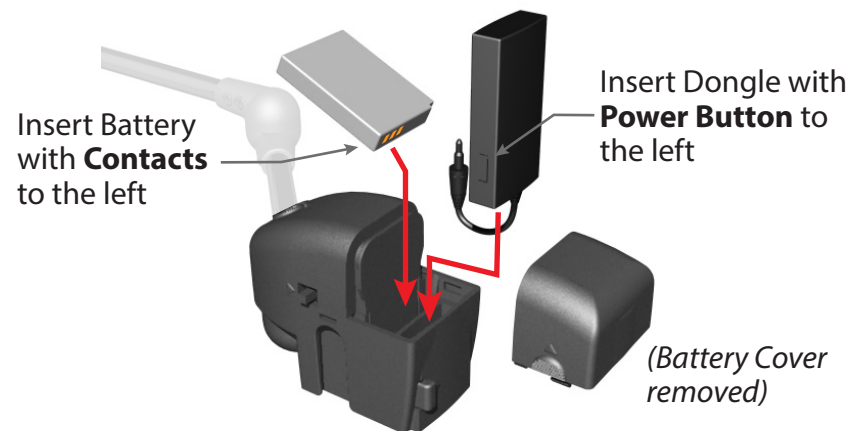

- Plug in **Dongle Plug** as shown.

To turn dongle OFF, or ON press and hold **dongle button** for 3 sec.

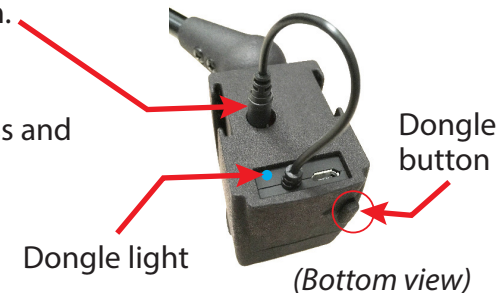

4 Calibrate

1. Place the walker on a **hard, flat surface**, and make sure there are **no objects** between the Sonar Guide and the floor.

2. Position the arm, and turn Power Switch **ON**. A **single beep**, and a **blinking green** LED indicate the beginning of calibration. When completed, you will hear **three beeps**.



Solid **green** LED indicates the Sonar Guide is **ready for use**.

5 Operate Sonar Guide

1) Position Sonar Guide

Sonar Guide arm needs to be positioned and extended away from the walker, and towards potential obstacles.

2) Detect Elevation Changes

Sonar Guide will detect changes in elevation (drop-offs and step-ups) of 3 or more inches. When a **change in elevation** is detected (drop-off or step-up), the **LED will turn blue** and you will hear a headset voice say **"ELEVATION"** (elevation has priority over obstacle)

3) Detect Obstacles

Sonar Guide detects obstacles in the user's path of travel below waist level at a distance of 2 feet from the sensor. *NOTE: obstacles beyond the width of the walker (to the right or left of the user) will not be detected.* When an **obstacle** is detected, the **LED will turn red** and you will hear a voice say **"OBSTACLE"**.

4) Turning Dongle & Headphones OFF

Press & hold **dongle** power button for **3 seconds**. Press & hold **headset** power button for **3 seconds** until **"Power off"** is heard.

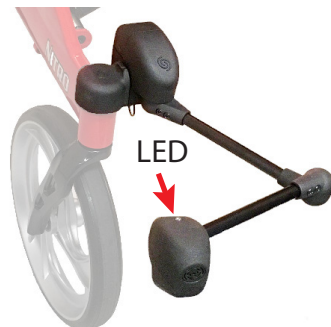

LED alerts color guide

Solid GREEN: ● The power is **ON**

Blinking GREEN: ● Sonar Guide is **calibrating**

Solid RED: ● **Obstacle** has been detected

Solid BLUE: ● **Drop-off/Step-up** detected

Beep tone guide

Single beep: Sonar Guide power is **ON**

Three beeps: Sonar Guide has **finished calibrating** and is ready

Package content

- | | |
|---------------------|-------------------------------|
| 1. Sonar Guide | 5. Rechargeable batteries (2) |
| 2. Nitro Adapter | 6. Battery charger |
| 3. Dolomite Adapter | 7. Dongle charger |
| 4. Dongle | 8. Headset |



G-TECHNOLOGY GROUP™

For more info contact:
G-Technology Group
571-249-1290, ex 1120
info@sonarglasses.com

